

CONFORMS TO STANDARDS

**BEDSIDE SLEEPERS (ASTM F2906-13(2019) &
BASSINETS AND CRADLES (ASTM F2194-16e1)**

Designed in the UK
Made in China



SnüzPod⁴®

Bedside Bassinet

Your guide to building your new
SnüzPod, and keeping it as a
safe and happy space to sleep

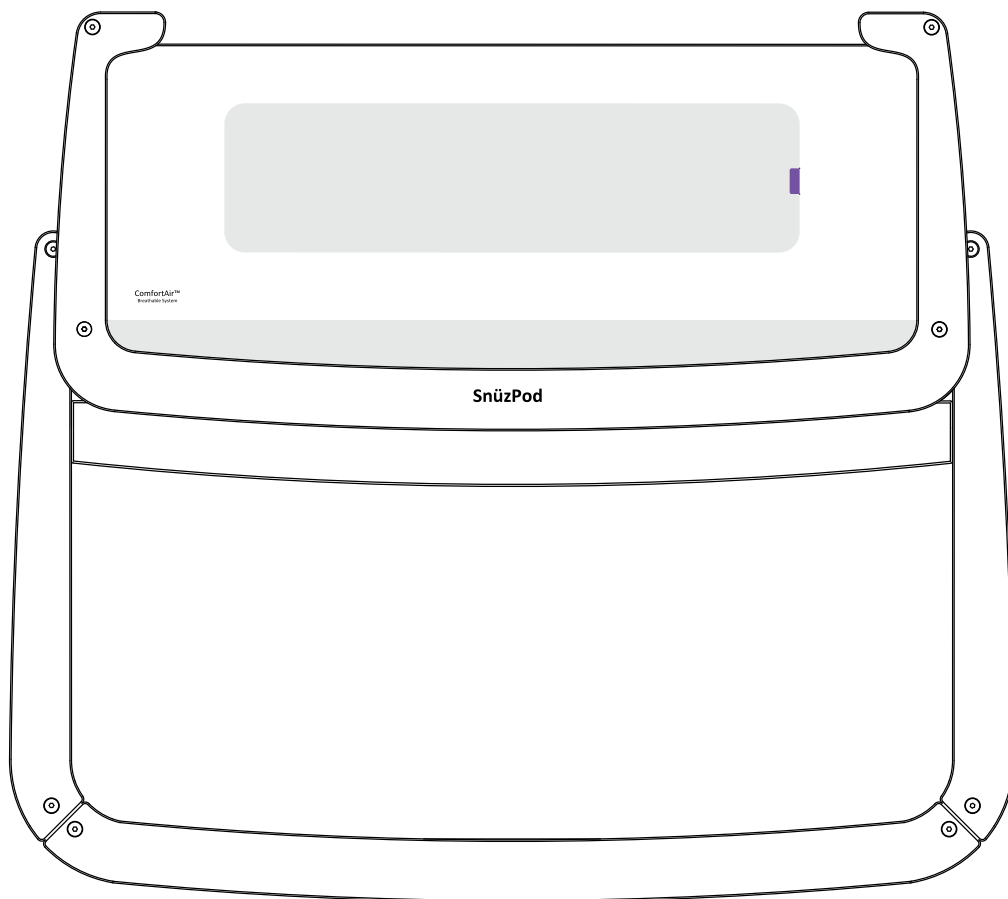

**For any help, assistance or guidance
please contact the Snüz team**

Tel: 844-444-1012

snuz.com/parts | Customer Service: hello@snuz.com

snuz.com



IMPORTANT:
KEEP FOR FUTURE REFERENCE.
READ CAREFULLY.

It's here,

Congratulations on your new arrival
and welcome to the Snüz family.

We're delighted you've chosen our
award-winning SnüzPod as your
baby's first bed and we hope that
they love it!



Assemble product and read the user guide



Snüz and share #snuzpod

Hello

Your guide to building your new SnüzPod, and keeping it as a safe and happy space to sleep.

We know you can't wait to use your new SnüzPod, but it is important to carefully read this guide for assembly & usage before use. Please be aware, that incorrect use of this bedside bassinet can be dangerous, and we want happy, safe and sleepy snüzing.

Please put this somewhere safe and keep it for future reference. For any help or advice, do not hesitate to call our helpline **844-444-1012**.

These illustrations are to be used as a guide only.

What's in the box?

Parts

If there is any part missing
or defective please visit

snuz.com/parts

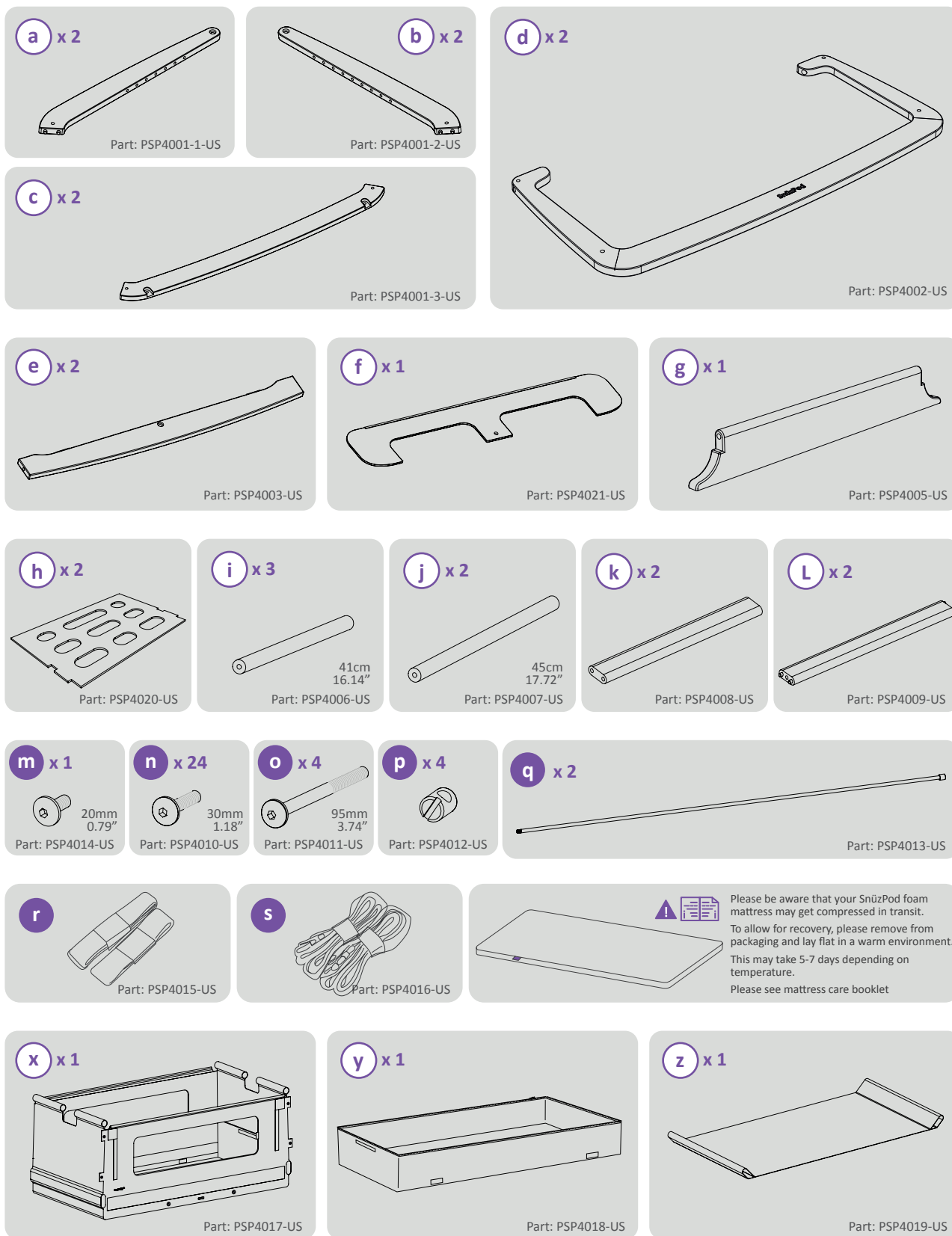

and you will also need...



50 min



x 1



x 1



x 1



Measure your bed

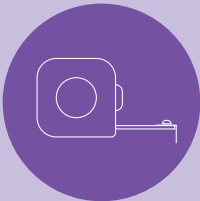

S. 1.

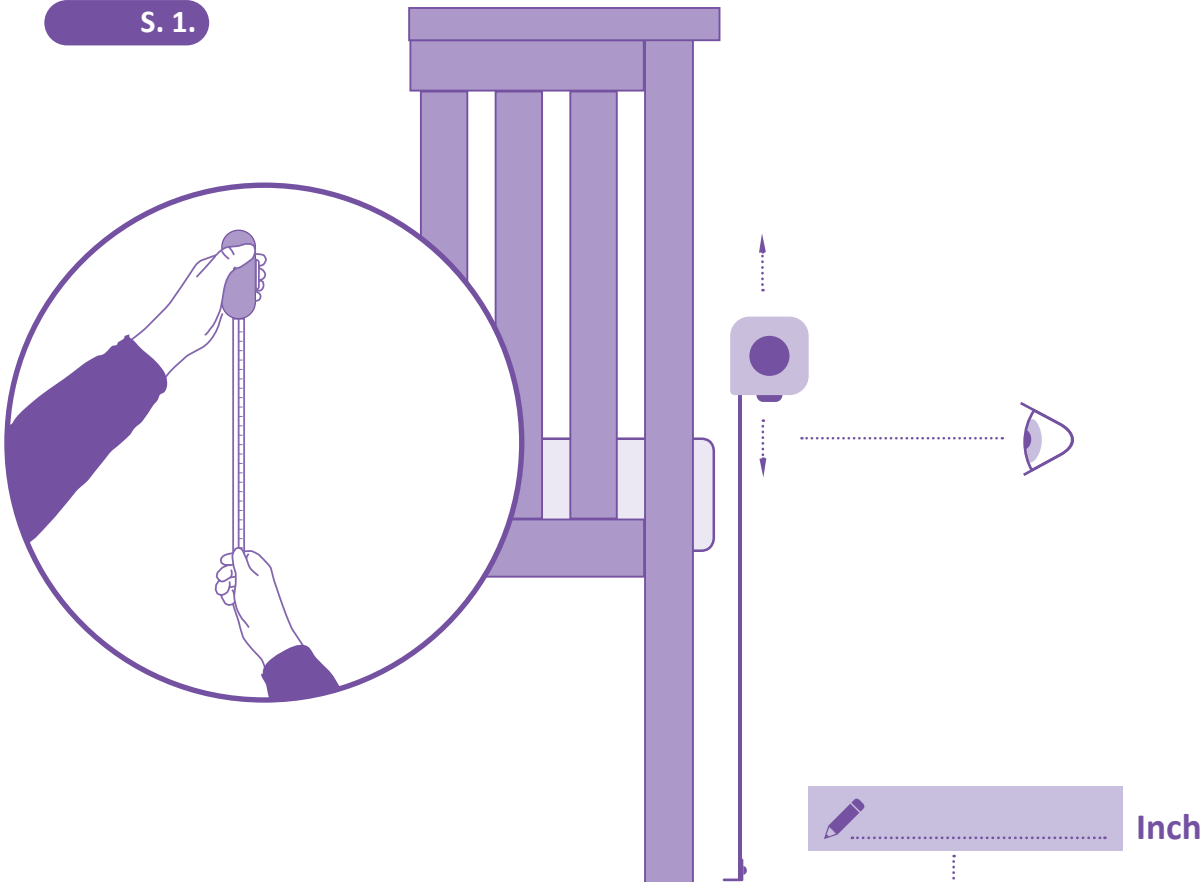

S. 2.

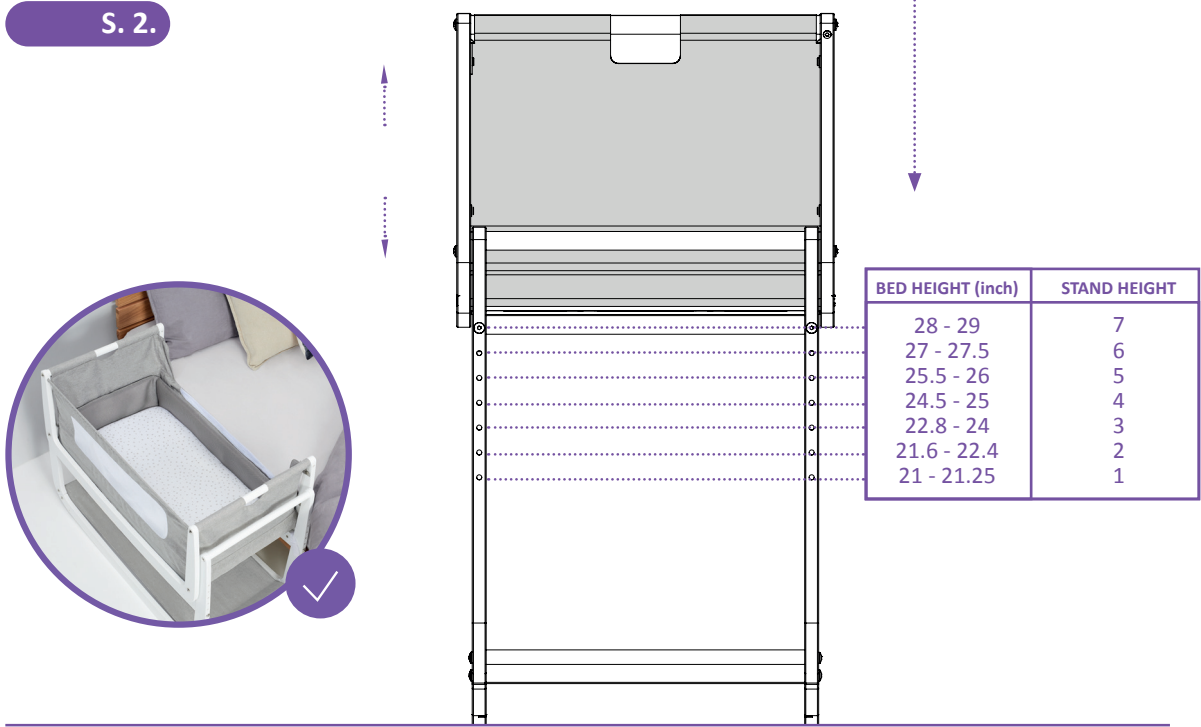

Measure

Stand

S. 3.

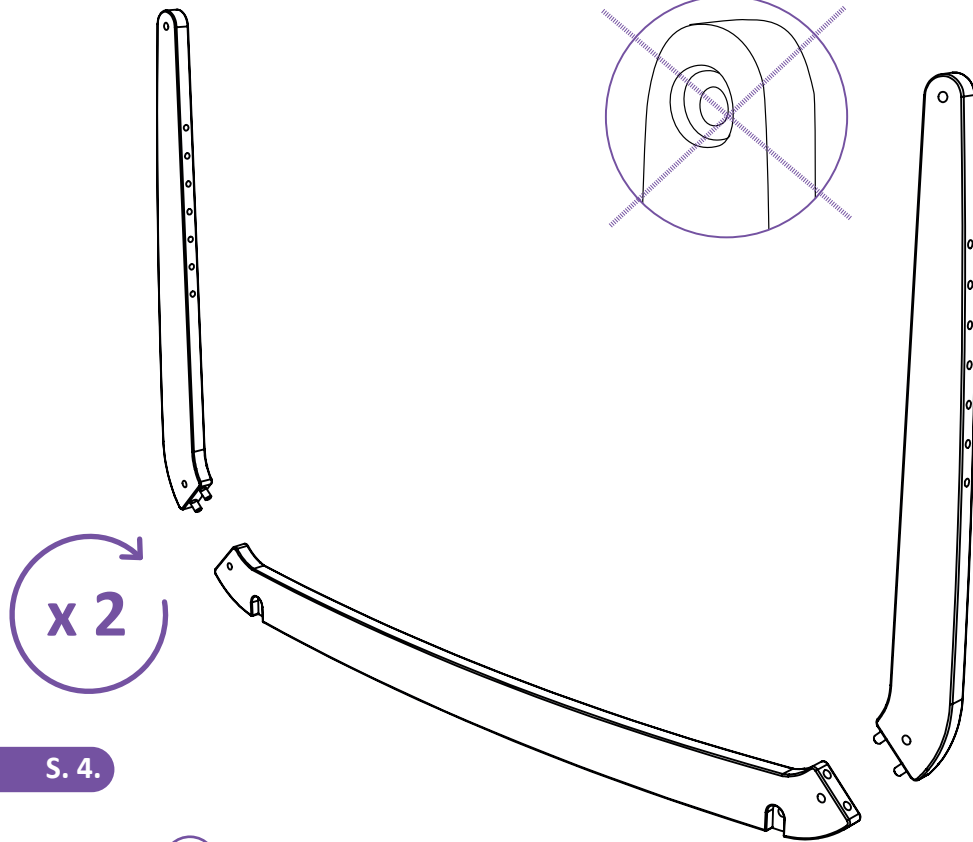

S. 4.

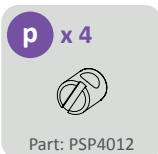
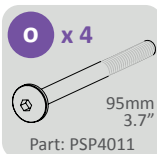
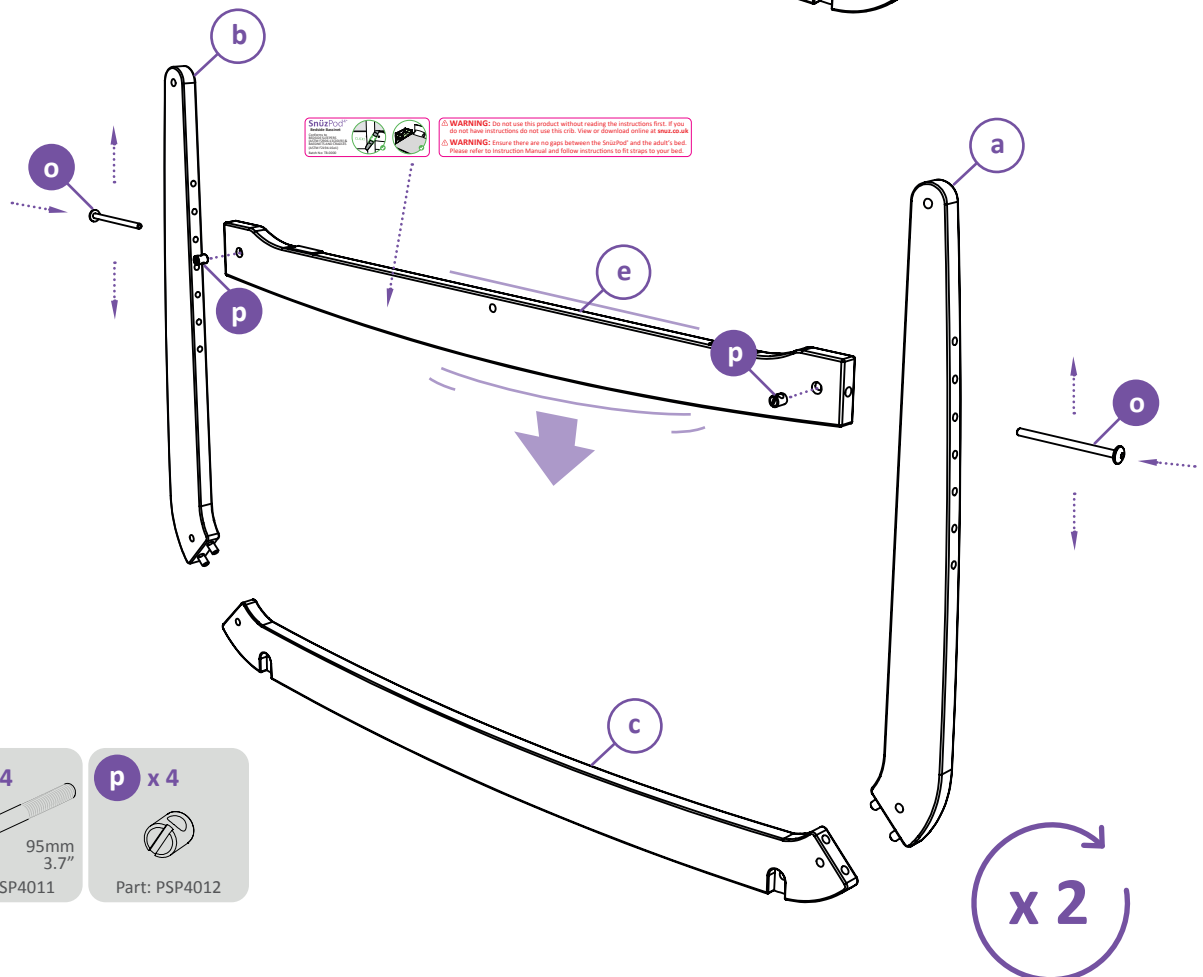

S. 5.



WARNING: Do not use this product without reading the instructions first. If you do not have instructions do not use this only. View or download online at: www.standuk.com
WARNING: Ensure there are no gaps between the StandPod® and the adult's bed. Please refer to instruction Manual and follow instructions to fit straps to your bed.

n x 7

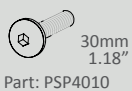

Part: PSP4010

i x 3

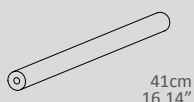

Part: PSP4006

k x 2

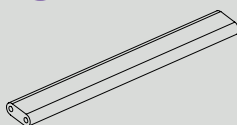

Part: PSP4008

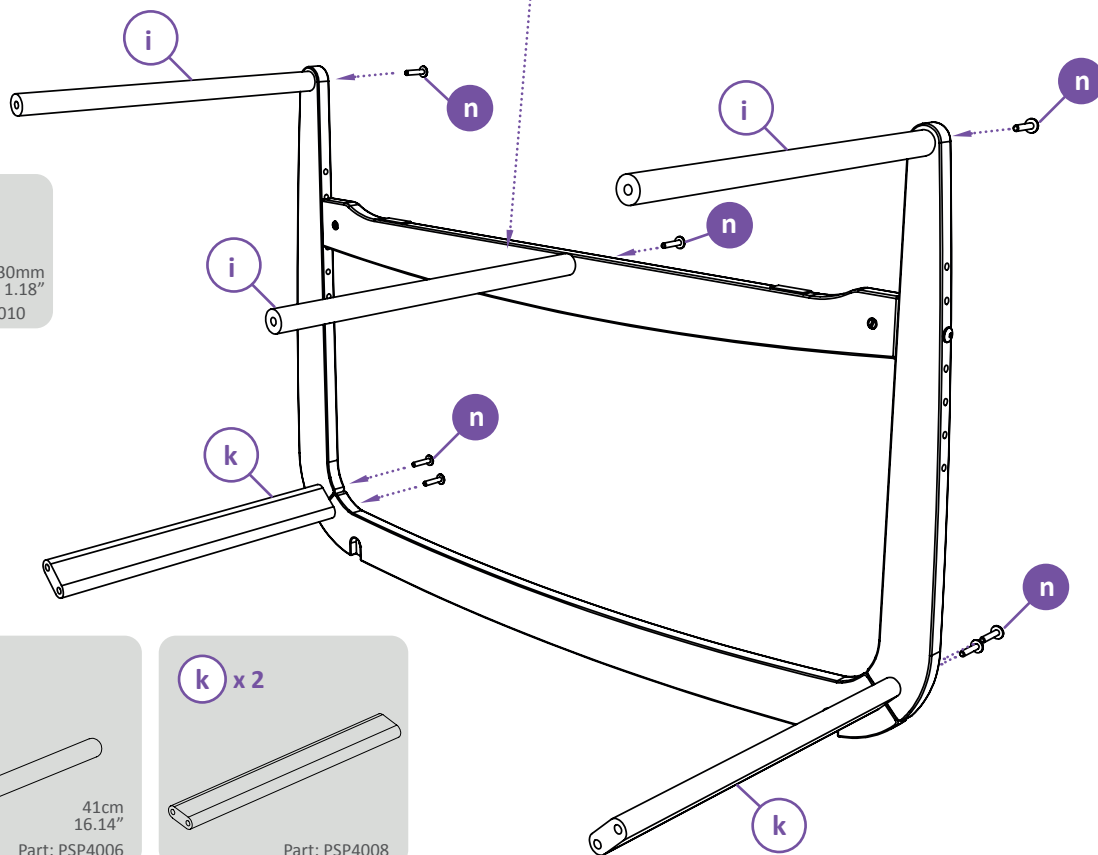

S. 6.

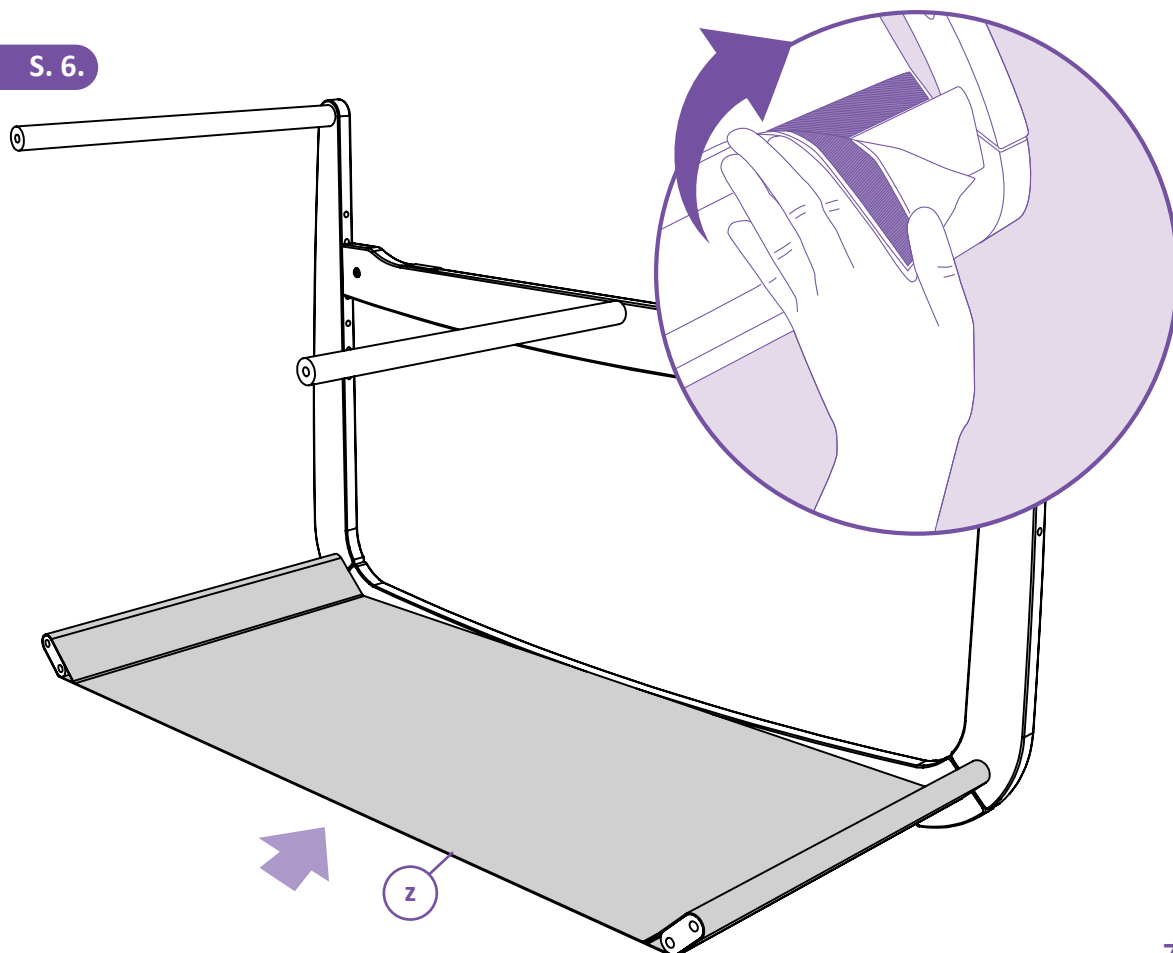

Stand

S. 7.

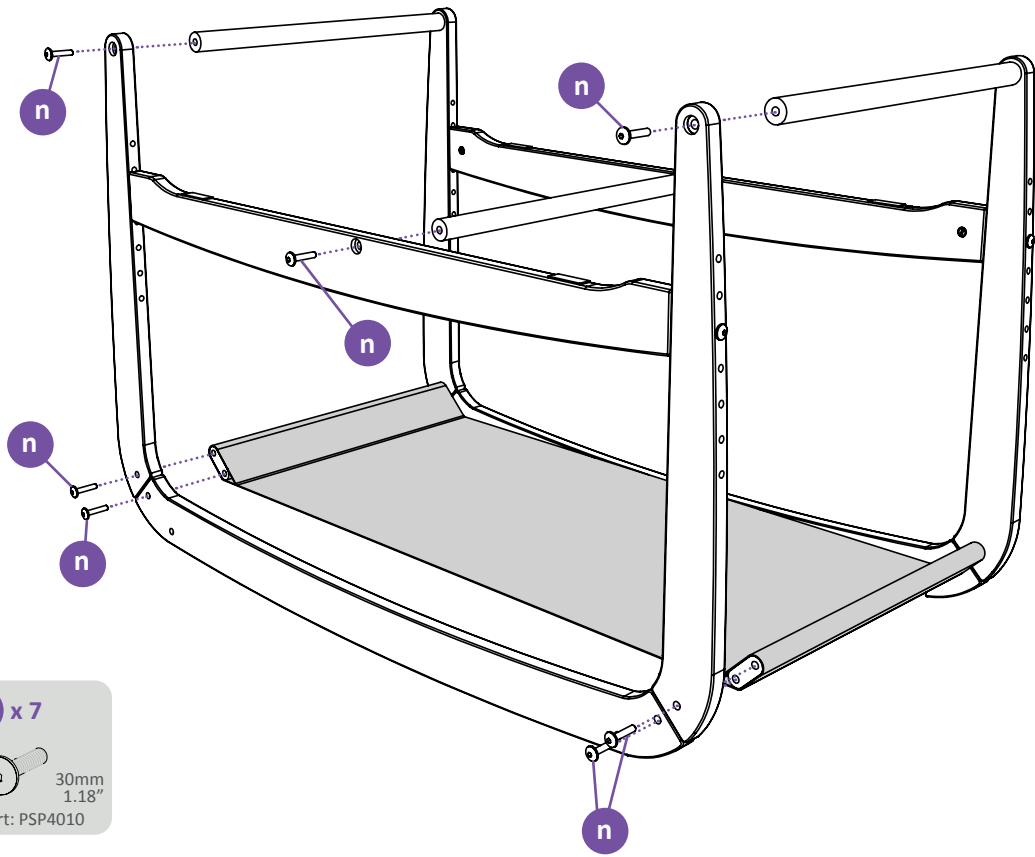

n x 7

30mm
1.18"
Part: PSP4010

S. 8.

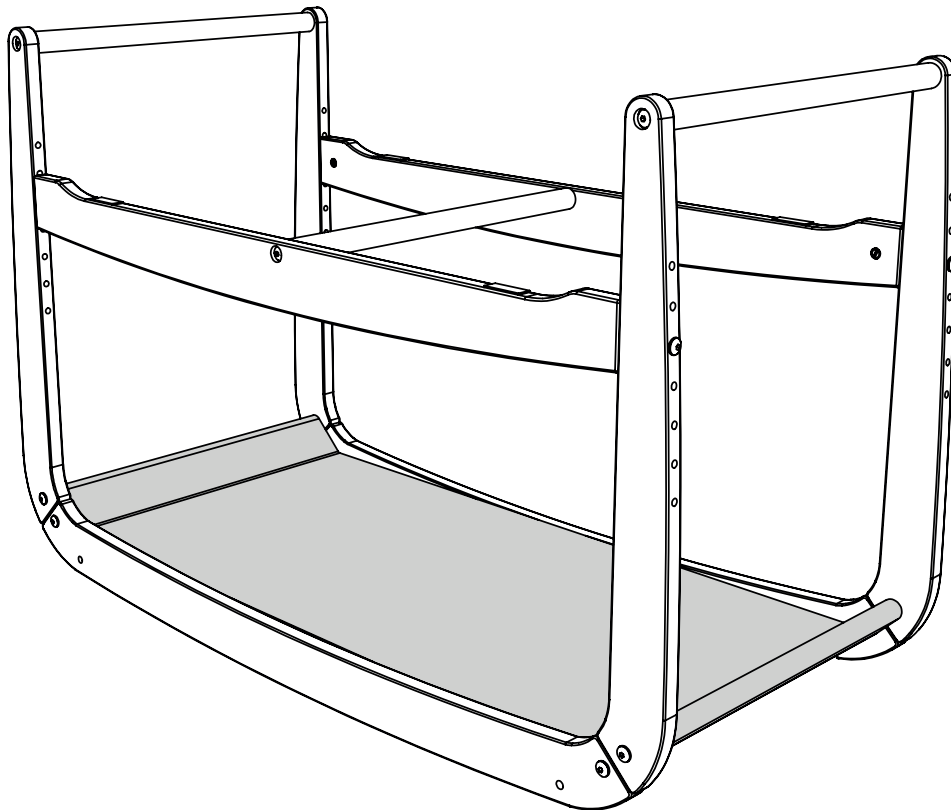

Bassinet

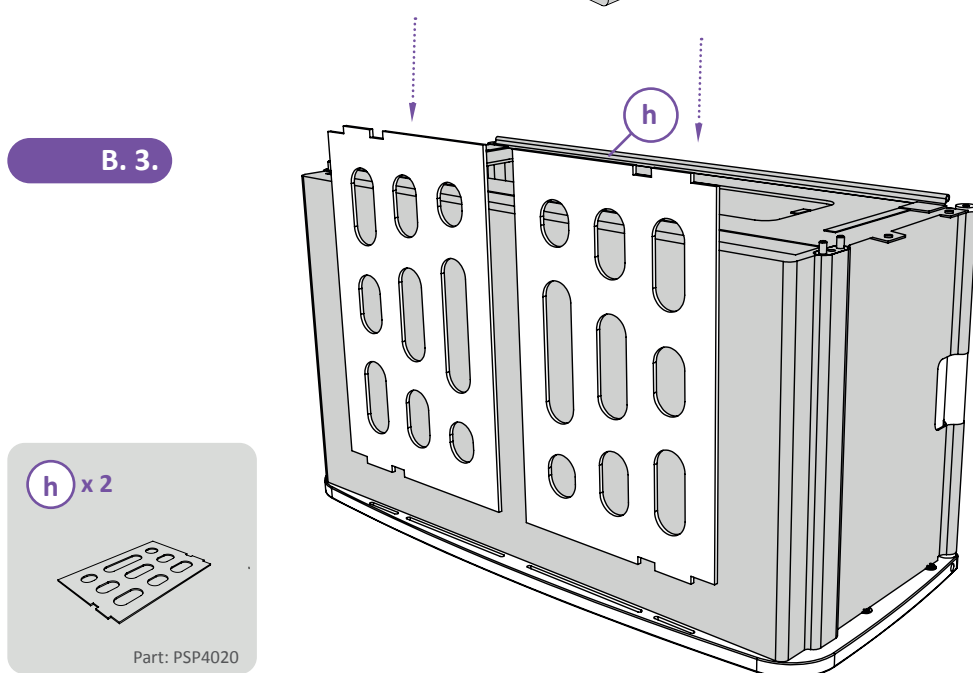
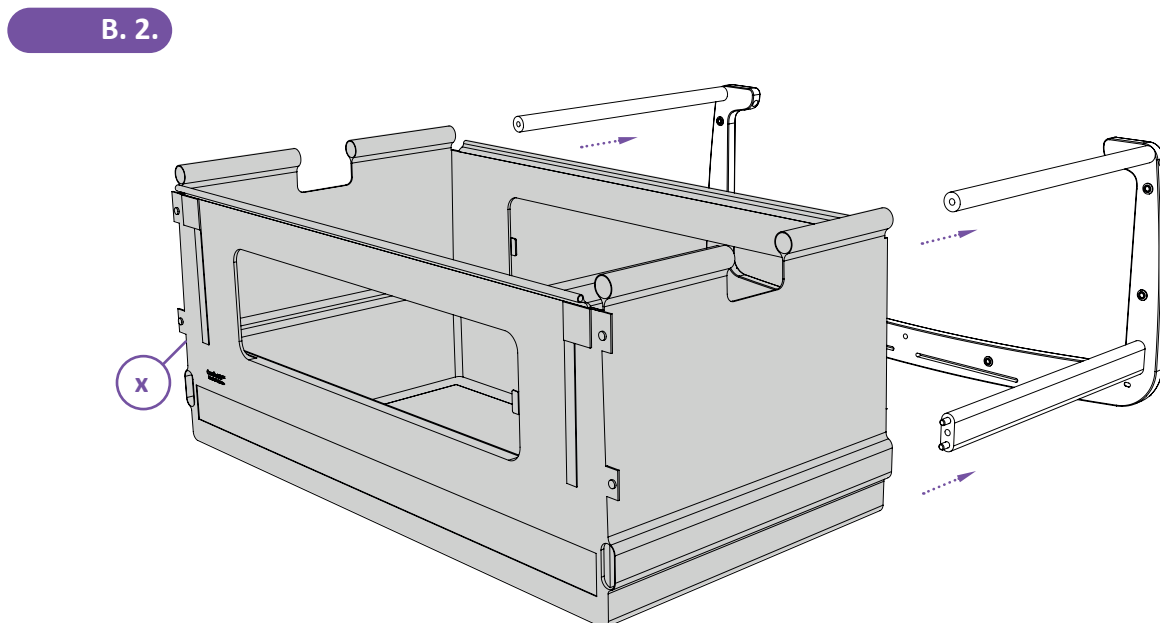
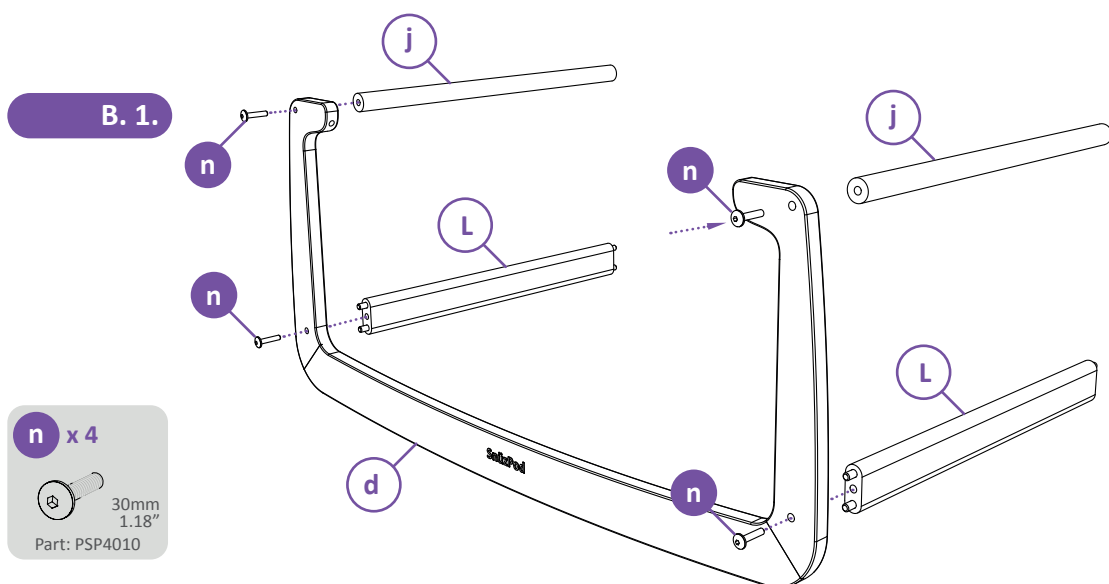

B. 4.

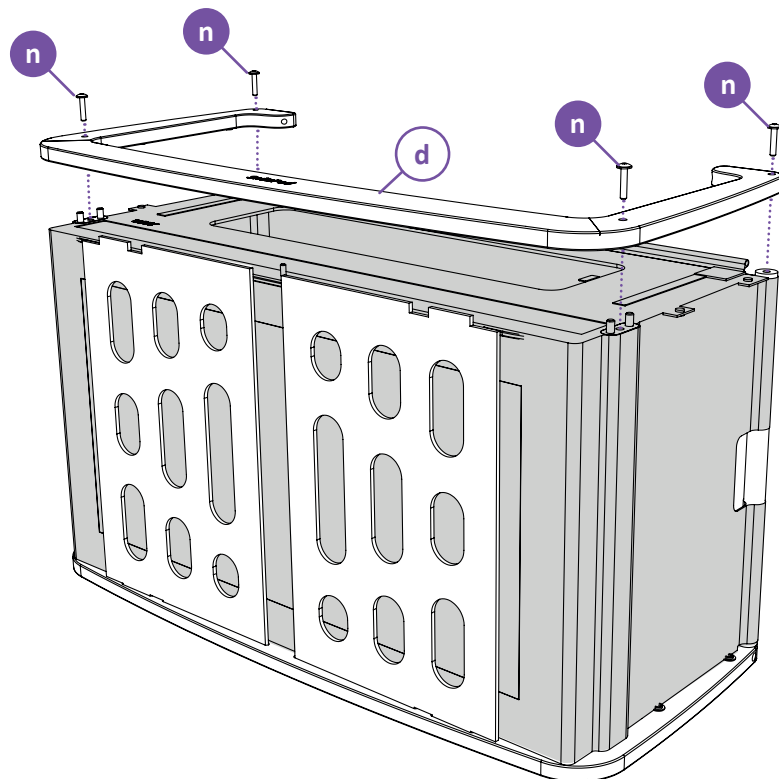

n x 4

30mm
1.18"
Part: PSP4010

B. 5.

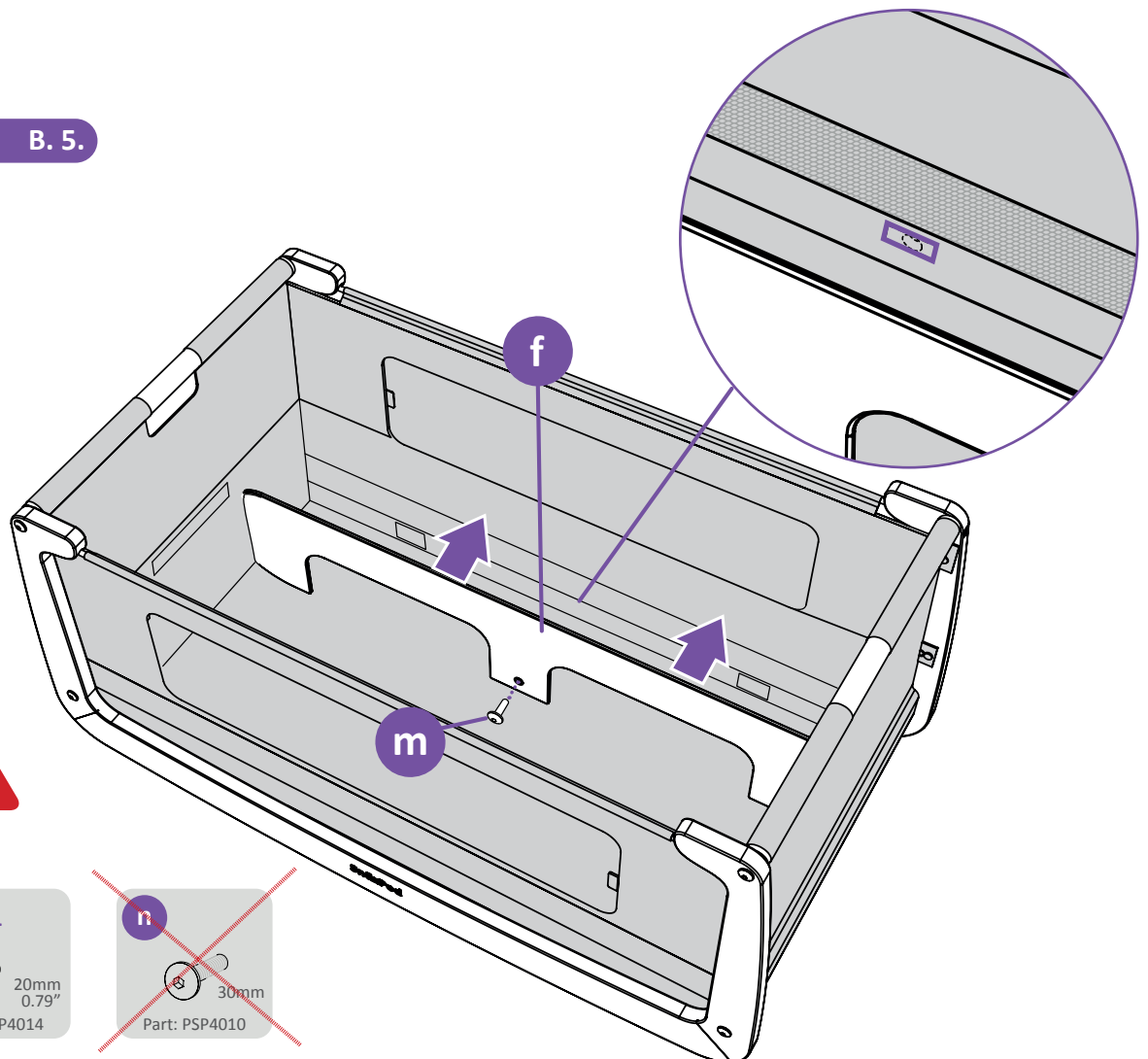

m x 1

20mm
0.79"
Part: PSP4014

~~**n**~~

~~30mm
1.18"
Part: PSP4010~~

B. 6.

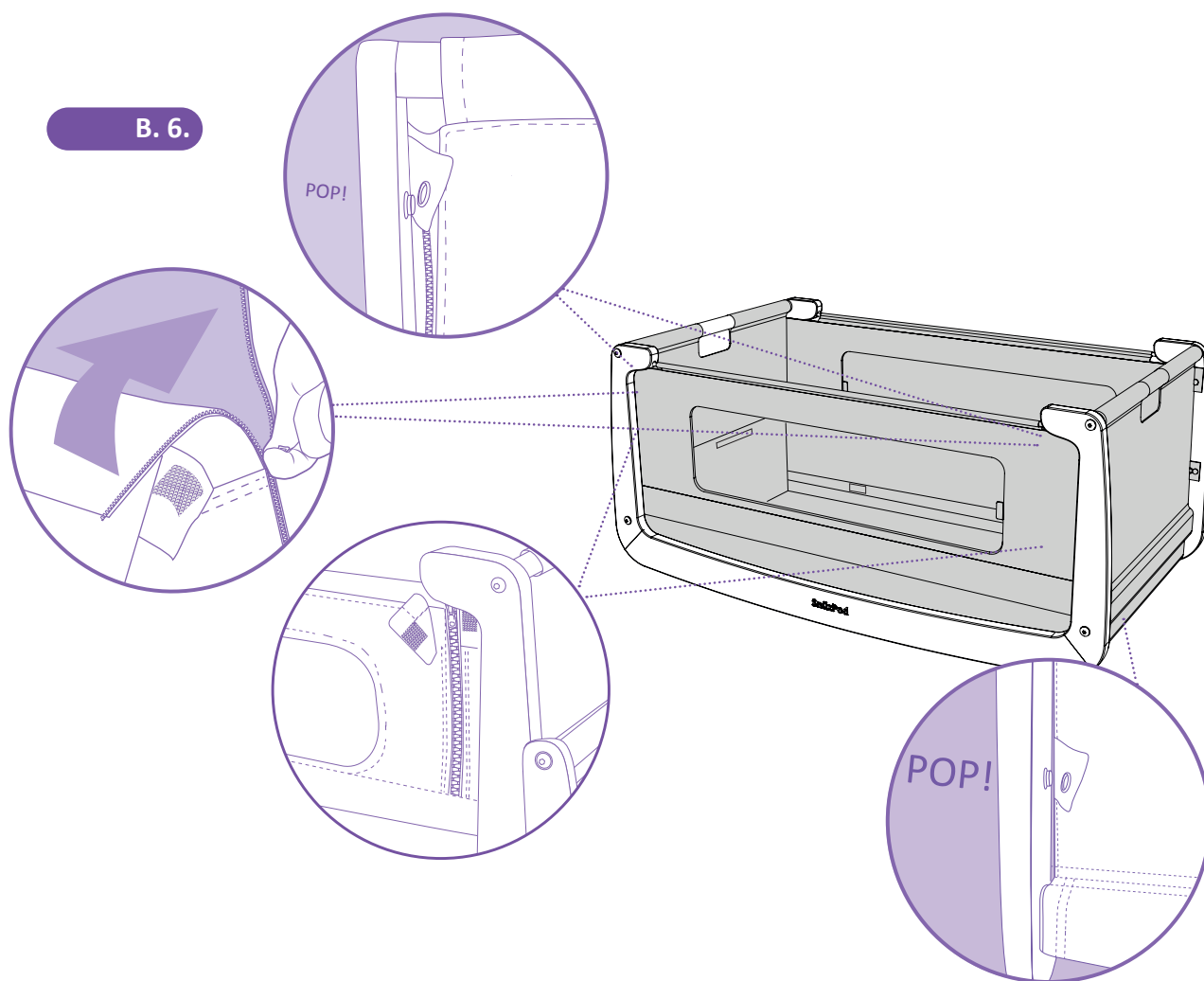

B. 7.

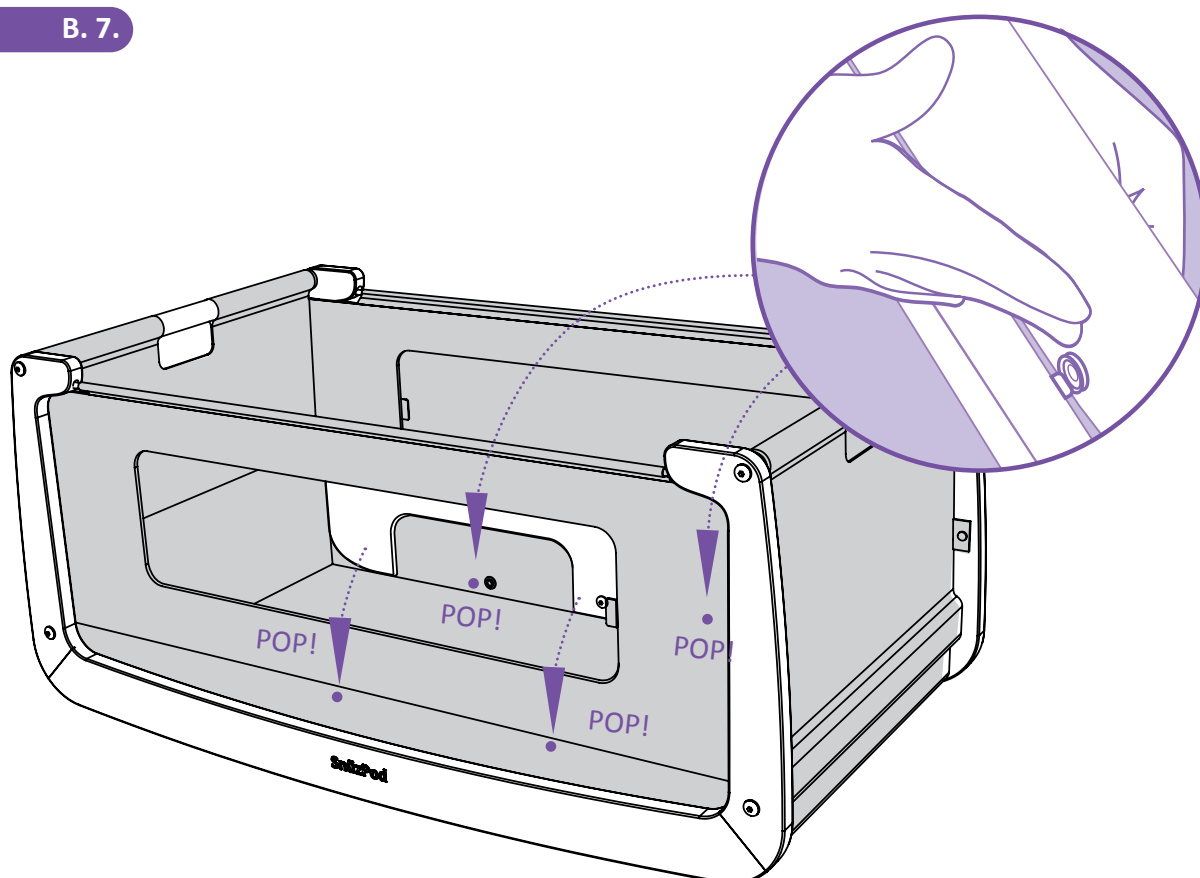

B. 8.

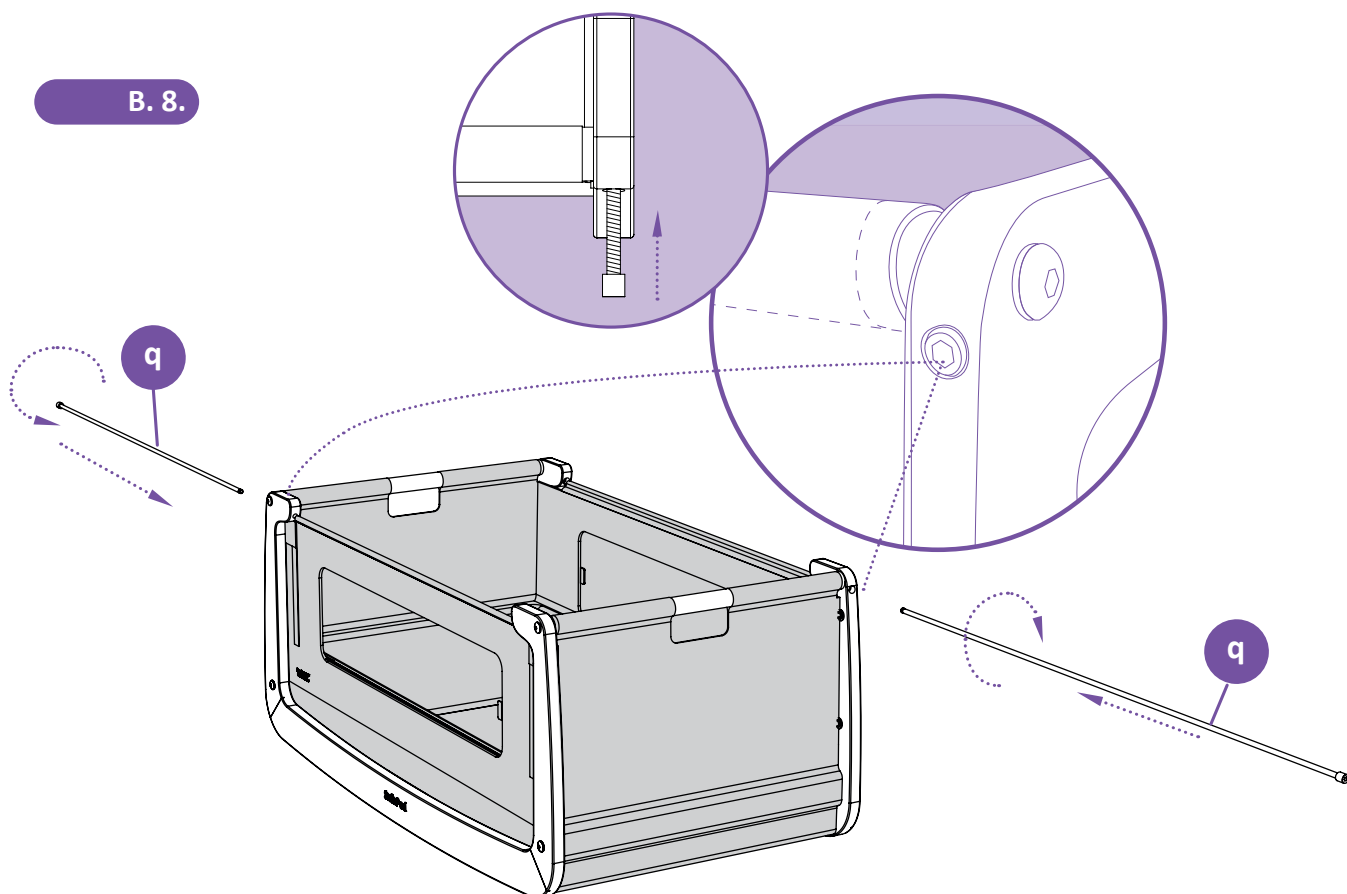

B. 9

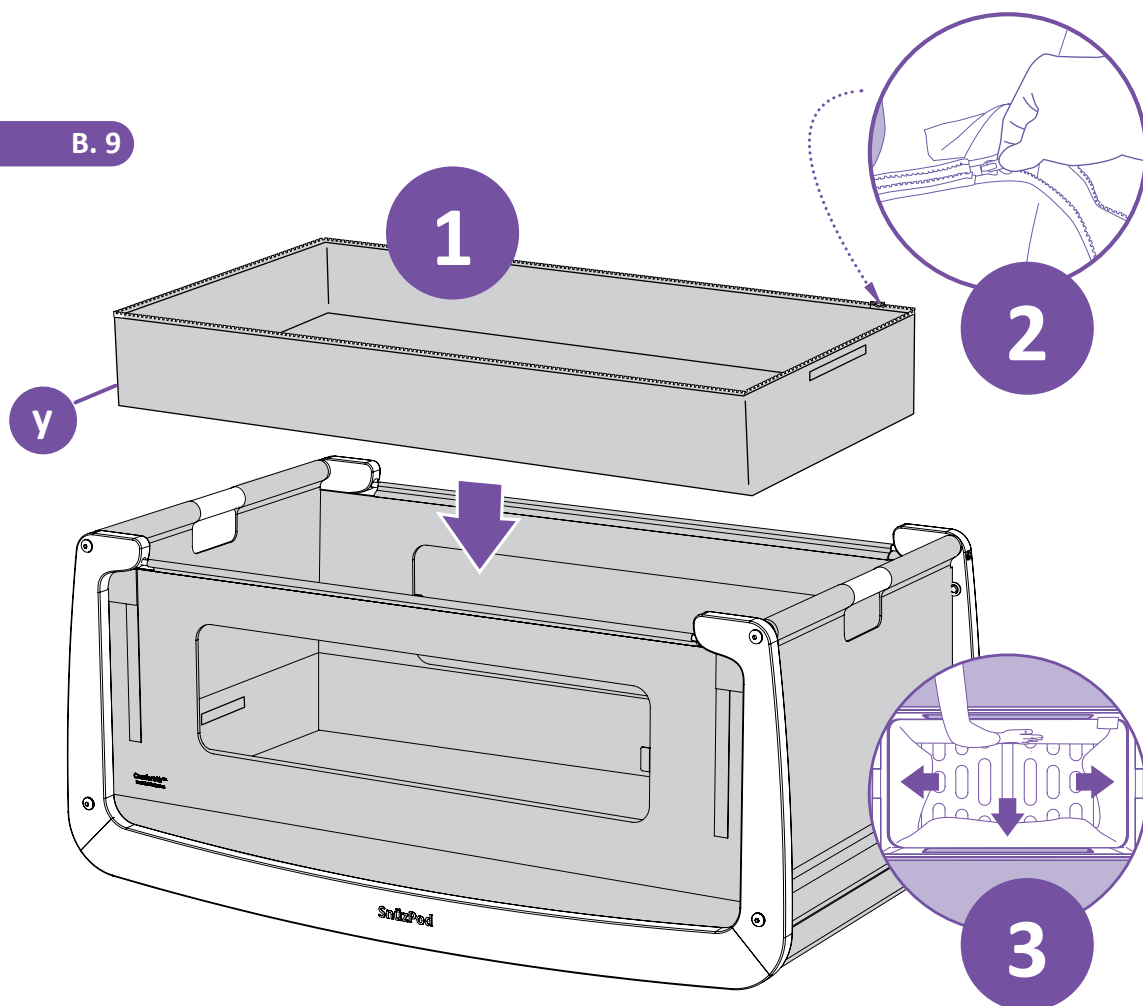

B. 10.

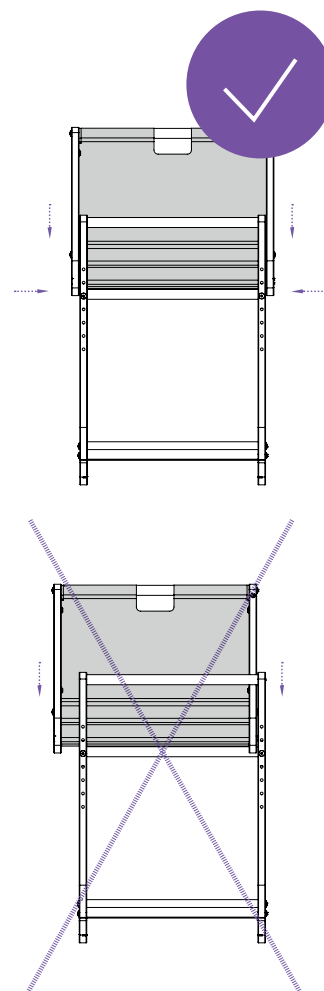
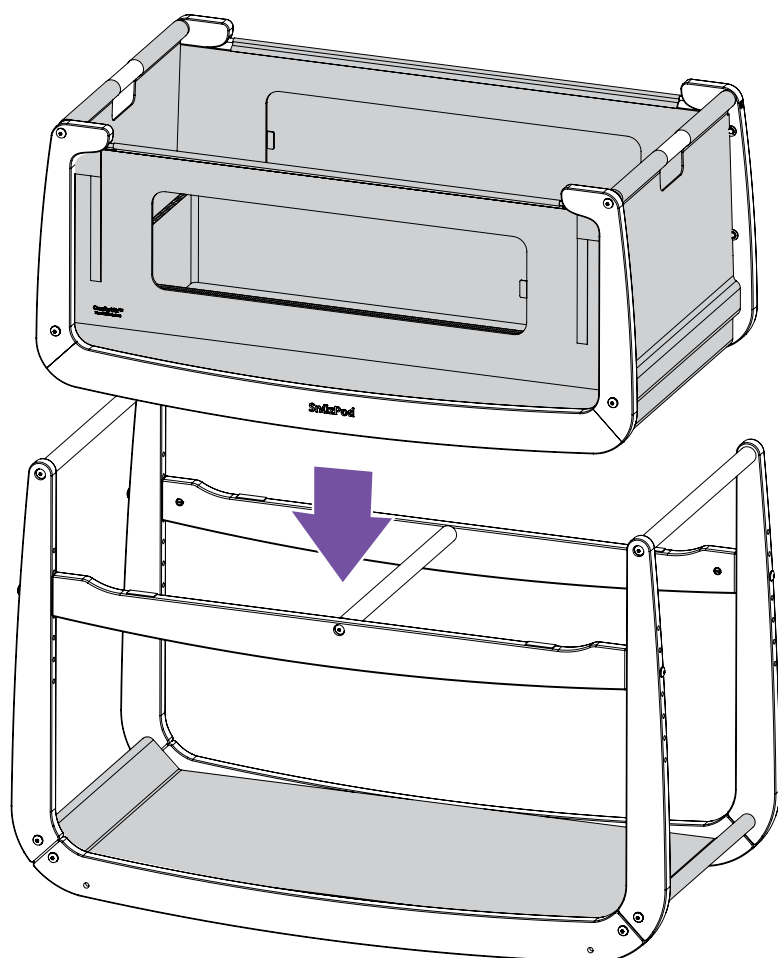
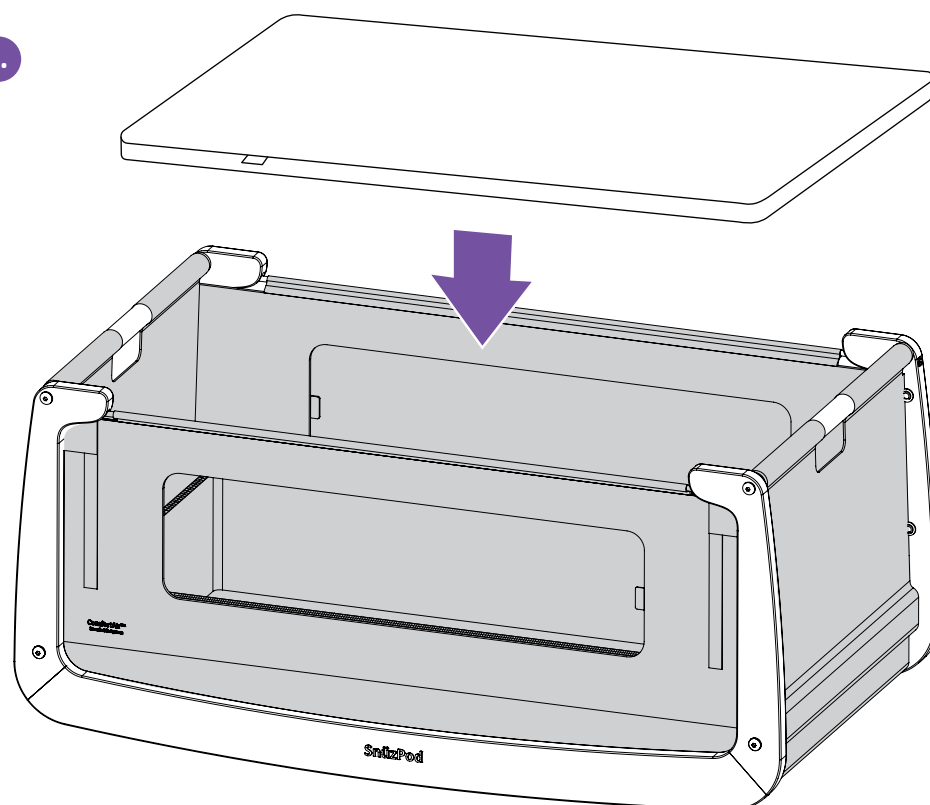

Bassinet

Reflux leg

R. 1.

n x 2

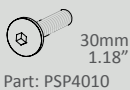

Part: PSP4010

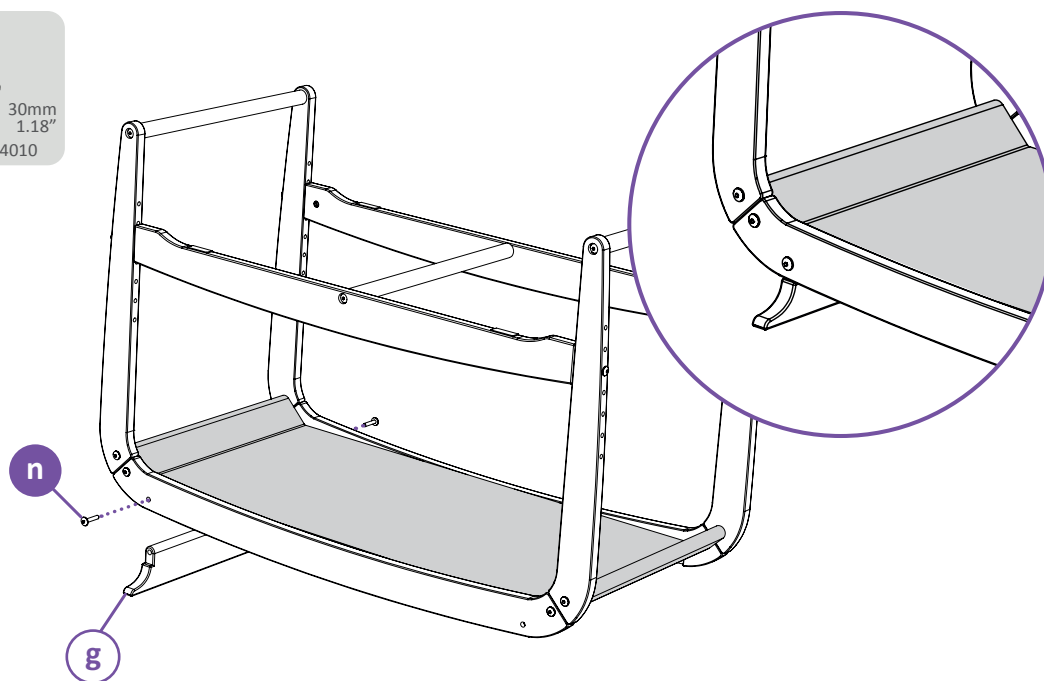

WARNING

The head of the child in the bassinet should never be lower than the body of the child.

Bedside sleepers shall never be used in an inclined position.

The reflux leg may only be used when the SnuzPod⁴ is used as a standalone bassinet and where the zip down wall is zipped up / closed.

Do not use the reflux leg during periods of sleep.

WARNING

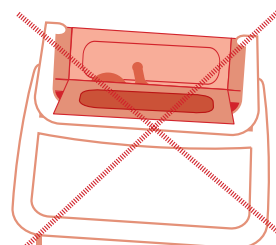
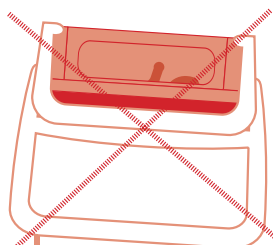
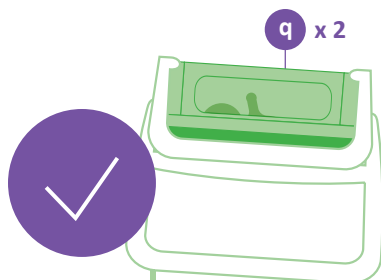

Using SnüzPod in Bedside Mode (fastened to bed)

When attached to your bed, SnüzPod⁴ has a permanent half-height wall to meet BEDSIDE SLEEPERS (ASTM F2906-13(2019) & BASSINETS AND CRADLES (ASTM F2194-16e1) .

- 1 Follow the instructions below to fit the straps to your bed - these will be tightened later.

Use the attachment system provided. Do not use another attachment system.

⚠ WARNING: Entrapment hazard - to prevent death from entrapment, bedside sleeper must be properly secured to adult bed using the attachment system.

Frame style bed

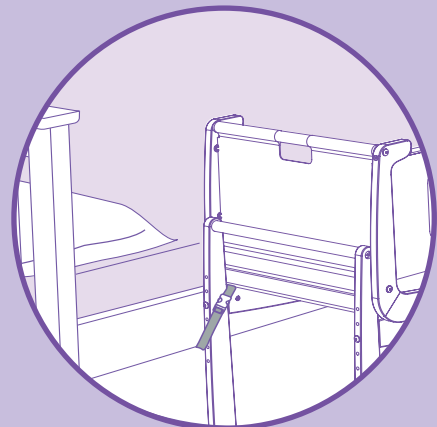
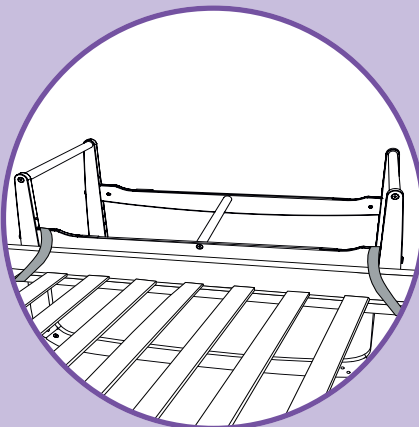
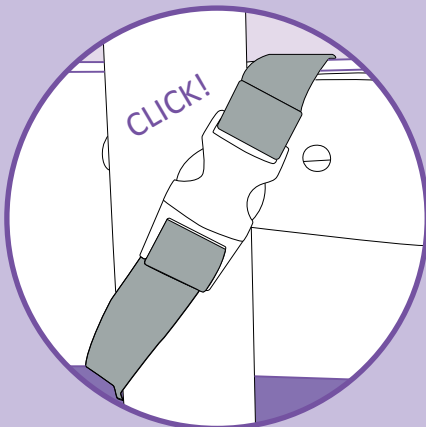
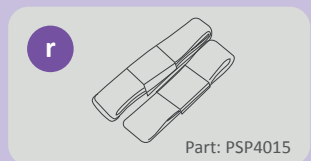

Divan or solid bed base

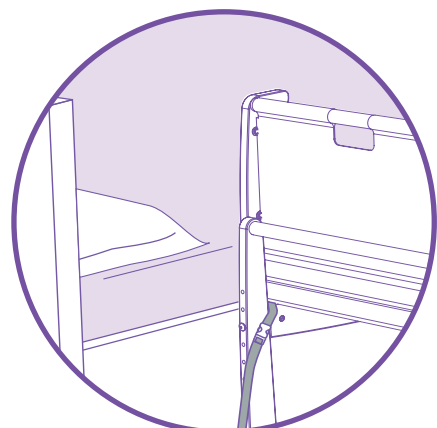
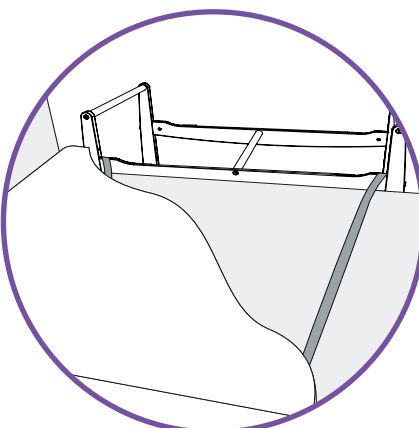
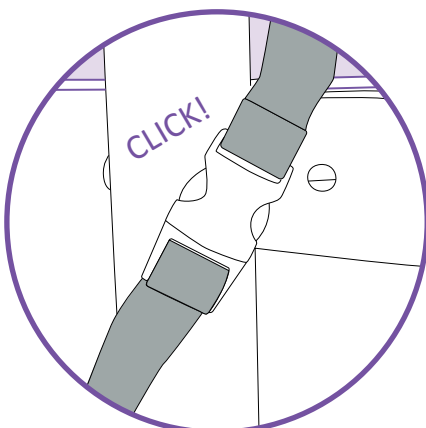
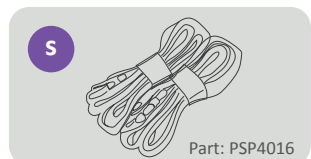

2 Remove the metal pole from the zip down wall.

⚠ WARNING:

Leaving the pole in situ could be hazardous.

Always retain the metal pole in the rear wall (the wall furthest away from your bed).

3 Release velcro tabs and lower the zips fully.

Fold the zip down wall down, tucking it in between the bassinet frame and the adult mattress.

4 Ensure that your mattress is level with the top of the zip down wall of the SnüzPod⁴.

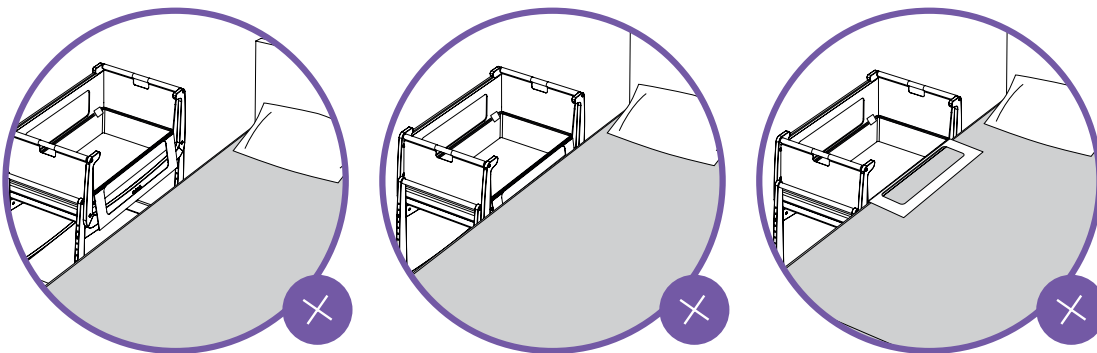
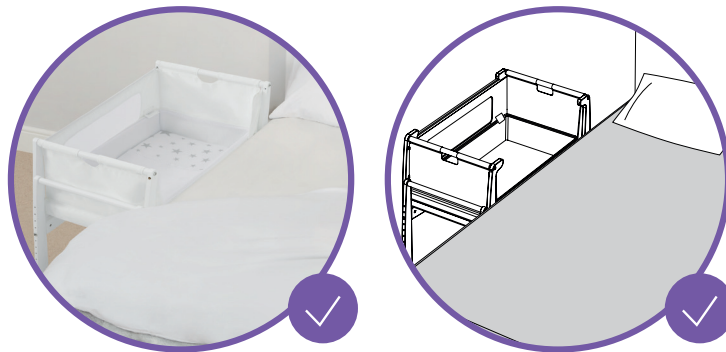

5 Tighten straps to secure the SnüzPod⁴ to your bed.

Ensure that the bassinet sits fully down on the stand and is not resting on any part of the parents' bed.

Do not over tighten the strap, as this may cause the stand to tilt. Ensure that the stand is flush with your bed frame / base.

Check the tightness of the attachment system before each use by pulling the bedside sleeper in a direction away from the adult bed.

Tuck any excess strap under your bed base, away from babies and children.

⚠ WARNING: Ensure there are no gaps between the SnüzPod and the adult's bed.

⚠ WARNING: During use, always ensure that the parents' bedding, sheets, blankets etc. do not enter or cover the inside of the bassinet.

IMPORTANT: RETAIN FOR FUTURE REFERENCE. READ CAREFULLY.

EN

Please take the time to carefully read the following warnings and recommendations, which are provided to keep your baby safe, whilst in your SnüzPod⁴ and also maintain safe, and proper use.

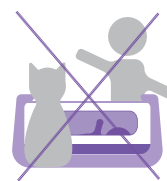

General Use

⚠️ WARNING: YOUR BABY'S SAFETY IS YOUR RESPONSIBILITY.

⚠️ WARNING: Failure to follow these warnings and the instructions could result in serious injury or death.

⚠️ WARNING: Do not use this product without reading the instructions for use first. Assemble product according to manufacturer's instructions for ANY use mode.

⚠️ WARNING: A bedside sleeper is designed to provide a sleeping area for an infant until 6 months old or until the baby begins to push up on hands and knees. Move your child to another sleeping product when your child reaches this stage.

⚠️ WARNING: FALL HAZARD
To help prevent falls, do not use this product when as soon as the child begins to push up on hands and knees or has reached 9KG (20lbs), whichever comes first.

⚠️ WARNING: Strings can cause strangulation! Do not place items with a string around a child's neck, such as hood strings or pacifier cords. Do not suspend strings over a bassinet or attach strings to toys.

⚠️ WARNING: To reduce the risk of SIDS pediatricians recommend healthy infants be placed on their backs to sleep, unless otherwise advised by your physician.

⚠️ WARNING: Do not use the product with more than one child at a time.

⚠️ WARNING: Do not use bassinet without the fabric bag.

⚠️ WARNING: Do not use bassinet/fabric bag without the ComfortAir liner.

⚠️ WARNING: Choking hazard – keep loose screws out of reach of children.

⚠️ WARNING: Keep metal poles away from babies and children.

⚠️ WARNING: Be aware of the risk of burning cigarettes, open fires and other sources of strong heat, such as electric bar fires, gas fires, etc. in the near vicinity of the bassinet.

- Maximum recommended weight of child is 9KG (20lbs).
- DO NOT use bassinet if any parts are missing, torn, damaged, or broken. Contact Snüz for replacement parts and instructional literature if needed. DO NOT substitute parts. Only use replacement parts supplied or approved by the manufacturer.
- Do not allow pets or other children to be left unattended/play unsupervised near the bassinet/bassinet and stand.
- Only use on a firm, horizontal level, and dry floor.
- The baby should be removed from the bassinet before any adjustment is made to the product.
- The baby should be removed from the bassinet before the product is carried or moved.
- We do not recommend using sleep positioners with this product and as per the guidance of safe sleep experts, only use a firm, flat mattress recommended specifically for use with the product.
- Only use the stand provided and ensure that the bassinet is securely fixed onto the stand when used as a bassinet or bedside bassinet.

WARNING: **SUFFOCATION HAZARD:**

Infants have suffocated

in gaps between extra padding and side of bassinet, and on soft bedding. Use only the mattress provided by the manufacturer. **NEVER** add a pillow, comforter or another mattress for padding.

Bedside Use

 **WARNING:** To avoid death from the child's neck being caught on the top rail on the side that is next to the adult bed, the top rail must not be higher than the adult bed mattress.

 **WARNING:** To avoid the risk of your child being strangled, the attachment system to the adult's bed shall always be kept away from and out of the bassinet.

 **DANGER!** Always completely raise the zip down wall when not attached to the adult's bed or when used as a bassinet. Ensure both zips are fully closed, tabs sealed and the metal poles (front and rear) are in situ.

 **WARNING:** The SnüzPod⁴ is not suitable for use with the following: folding or sofa beds, guest beds, high sleeper or low floor beds with protruding frames including futon beds, antique beds and water beds.

 **WARNING:** During use, always ensure that the parents' bedding, sheets, blankets etc. do not enter or cover the inside of the bassinet.

 **WARNING:** There must be no more than 1/2 inch (13mm) gap between bedside sleeper and adult bed. Check tightness before each use by pulling bedside sleeper in a direction away from adult bed. If gap exceeds 1/2 inch (13mm), **DO NOT** use product. Do not fill the gap with pillows, blankets or other items that are suffocation hazards.

- Suitable for use with beds where the top surface of the adult mattress is a maximum of 28.74" (73cm) from the floor.
- The SnüzPod⁴ should not be used as a bedside bassinet outside of the guide height shown in these instructions. This bedside bassinet is designed for use only with adult beds that are between 21 and 29 inches from the floor to the top of the adult mattress.
- To prevent suffocation, the bassinet should be securely attached to the adult's bed using the straps provided only. Ensure the stand is securely attached to the bed frame in line with the user guide and ensure all excess strap material and poles are kept away from babies and children.
- When used in bedside bassinet mode, have the zip down wall tucked in between the bassinet frame and the adult mattress. Always remove the metal pole from the zip down wall, to allow the wall to fully drop down. Leaving the pole in situ could be hazardous.

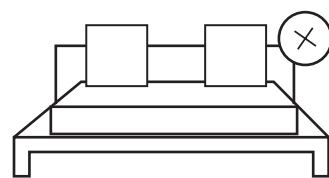
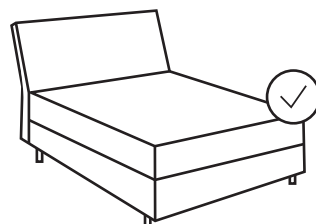

Please ensure mattress, boxsprings and frame are all aligned.

Mattress

 **WARNING:** Do not use more than one mattress in the product.

 **WARNING:** If using a sheet with the mattress, use only one provided by Snüz or one specifically designed to fit the dimension of the bassinet.

- The recommended mattress size for the bassinet is 29.72x15.75x1.18" (75.5cm x 40cm x 3cm) thick. Always ensure that the mattress height does not exceed 1.18" (3cm). The top of any mattress used should not be higher than the mark on the inside of the bassinet leg – a small notch 0.39" (1cm) long. You may need to move the bag aside to see this fully. Ensure the internal dimensions of the bassinet are no greater than 0.72" (2cm) larger than the length and width of your mattress.

Caring for your SnüzPod⁴

- Check your SnüzPod⁴ regularly. All assembly fittings should always be tightened properly and care should be taken that no screws are loose, because a child could trap parts of the body or clothing (e.g. strings, necklaces, ribbons for babies' dummies, etc.), which would pose a risk of strangulation.
- Regularly check that the fabric bag is securely and properly attached to the bassinet - before every use; ensuring that the poppers and metal poles are in situ. Regularly hand tighten screws, avoiding over-tightening as this may cause cross threading and damage.
- Do not dry clean. Your SnüzPod⁴ can be wiped/sponged clean with a mild detergent. The fabric bag can be removed from the frame, and hand washed according to the fabric bag care label. The ComfortAir liner can be machine washed according to the care label.
- This is a natural product and may be affected by extremely dry, humid, or damp atmospheres.
- Store away from direct heat, or away from places of extreme temperature fluctuations such as roof attics, by outside walls, or near single glazed windows.



THE QUEEN'S AWARDS
FOR ENTERPRISE:
INNOVATION



@snuzusa
#snuzpod